

**SPECIFICATION:**

JOSAM SERIES 19800 ELASTOMERIC NEOPRENE GASKET  
CONFORMING TO ASTM-C564 STANDARD FOR WATER-TIGHT SEAL  
WITH PIPE IN JOSAM INSIDE CAULK OUTLETS (-X).

**GASKET  
JIFFEE JOINT**

SERIES **19800**

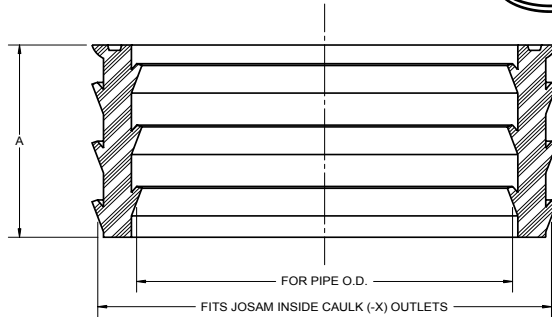

TYPE NO.	DESIGNATION	FOR PIPE O.D.		A
		MIN.	MAX.	
19802	2" SW	2.125	2.390	1-1/2
19803	3" SW	3.125	3.390	1-3/4
19804	4" SW	4.125	4.390	2-1/4
19805	5" SW	5.210	5.390	2-1/2
19806	6" SW	6.210	6.390	2-5/8
19812	2" XH	2.290	2.470	1-1/2
19813	3" XH	3.410	3.590	1-3/4
19814	4" XH	4.410	4.590	2-1/4
19815	5" XH	5.410	5.590	2-1/2
19816	6" XH	6.410	6.590	2-5/8
19825	5" SP	5.550	5.700	2-1/2
19826	6" SP	6.550	6.700	2-5/8

DATE OF LAST CHANGE: 06/20/08

DIMENSIONS ARE SUBJECT TO MANUFACTURERS  
TOLERANCES AND CHANGE WITHOUT NOTICE.  
WE CAN ASSUME NO RESPONSIBILITY FOR  
USE OF SUPERSEDED OR VOID DATA.

**JOSAM COMPANY**  
MICHIGAN CITY, INDIANA

NOTES

## Installing JOSAM Products Using the JIFFEE-JOINT Gasket.

1. Set drain body to the proper height over pipe.
2. Level and support in place.
3. After coating gasket and inside of drain with a gasket lubricant, slip gasket over pipe and press down as far as possible by hand.
4. Placing a caulking tool in groove at top of gasket, drive the gasket down flush with the pipe top – no further. You have made a perfect joint.

### GASKET-PIPE TABLE

TYPE NO.	CAST IRON		PVC			COPPER		
	SOIL PIPE XH	SW	NO HUB	PLASTIC ABS	THIN PVC WALL	STEEL DWV	GLASS	
19802	•				•	•	•	
19803	•				•	•		
19804	•	•			•	•		
19805	•	•						
19806		•						
19812	•		•	•		•	•	
19813	•			•	•	•	•	
19814	•			•	•	•	•	
19815	•							
19816	•							
19825				•	•	•		
19826				•	•	•	•	

SW – Service Weight      XH – Extra Heavy      SP – Steel Pipe

These recommendations apply to pipe that conforms to ANSI, ASTM and other applicable standards. JIFFEE-JOINT Gaskets are designed for use only with JOSAM caulk outlet (-X) products.