

DIMENSION OF SOCKETS

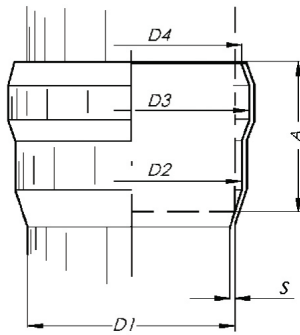

SERIES NUMBER	PIPE SIZE NOM.	A - MIN INSERT DEPTH	D1 (PIPE O.D.)	D2	D3	D4	S
JP-0100	1½"	1.2 (30)	1.7 (42)	1.8 (45)	1.9 (48)	1.8 (45)	.04 (1.0)
JP-0200	2"	1.5 (38)	2.1 (53)	2.2 (56)	2.4 (60)	2.2 (56)	.04 (1.0)
JP-0300	3"	2.2 (55)	2.9 (73)	3 (76)	3.2 (81)	3 (76)	.05 (1.25)
JP-0400	4"	2.8 (70)	4.0 (102)	4.2 (106)	4.5 (114)	4.2 (107)	.05 (1.25)
JP-0600	6"	3.1 (80)	6.3 (159)	6.5 (164)	6.9 (176)	6.6 (168)	.06 (1.5)
JP-0800	8"	4.7 (120)	8.6 (219)	8.8 (224)	9.5 (241)	8.9 (227)	.08 (2.0)

PUSH-FIT PIPE WITH EPDM GASKETED SOCKET

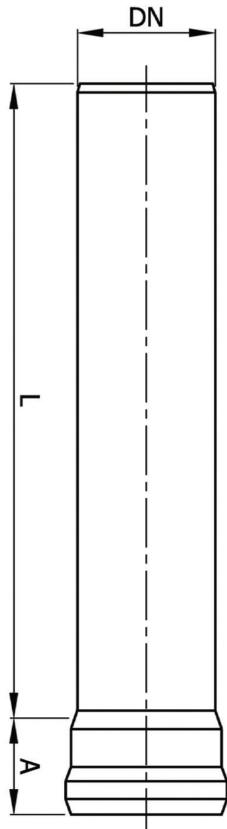

SERIES NUMBER	PIPE SIZE NOM.	A - MIN INSERT DEPTH	L FT.- (MM)	WT LBS.	DN PIPE O.D. IN. - (MM)
JP-0108	1½"	1.2 (30)	0.8 (250)	.75	1.7 (42)
JP-0116	1½"	1.2 (30)	1.6 (500)	1.3	1.7 (42)
JP-0125	1½"	1.2 (30)	2.5 (750)	1.9	1.7 (42)
JP-0133	1½"	1.2 (30)	3.3 (1,000)	2.4	1.7 (42)
JP-0149	1½"	1.2 (30)	4.9 (1,500)	3.5	1.7 (42)
JP-0166	1½"	1.2 (30)	6.6 (2,000)	4.7	1.7 (42)
JP-0182	1½"	1.2 (30)	8.2 (2,500)	6.3	1.7 (42)
JP-0198	1½"	1.2 (30)	9.8 (3,000)	6.7	1.7 (42)
JP-0208	2"	1.5 (38)	0.8 (250)	.93	2.1 (53)
JP-0216	2"	1.5 (38)	1.6 (500)	1.6	2.1 (53)
JP-0225	2"	1.5 (38)	2.5 (750)	2.2	2.1 (53)
JP-0233	2"	1.5 (38)	3.3 (1,000)	3.2	2.1 (53)
JP-0249	2"	1.5 (38)	4.9 (1,500)	4.3	2.1 (53)
JP-0266	2"	1.5 (38)	6.6 (2,000)	5.7	2.1 (53)
JP-0282	2"	1.5 (38)	8.2 (2,500)	6.9	2.1 (53)
JP-0298	2"	1.5 (38)	9.8 (3,000)	8.5	2.1 (53)
JP-0308	3"	2.2 (55)	0.8 (250)	1.6	2.9 (73)
JP-0316	3"	2.2 (55)	1.6 (500)	2.8	2.9 (73)
JP-0325	3"	2.2 (55)	2.5 (750)	4.5	2.9 (73)
JP-0333	3"	2.2 (55)	3.3 (1,000)	5.2	2.9 (73)
JP-0349	3"	2.2 (55)	4.9 (1,500)	7.6	2.9 (73)
JP-0366	3"	2.2 (55)	6.6 (2,000)	10.6	2.9 (73)
JP-0382	3"	2.2 (55)	8.2 (2,500)	12.5	2.9 (73)
JP-0398	3"	2.2 (55)	9.8 (3,000)	14.6	2.9 (73)