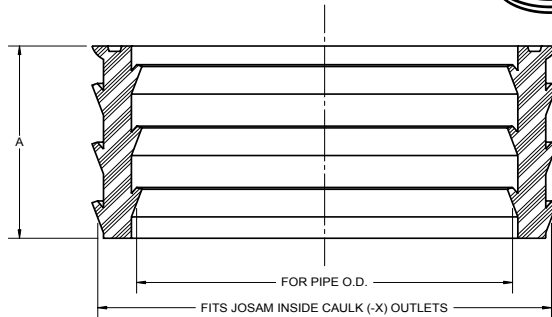

SPECIFICATION:

JOSAM SERIES 19800 ELASTOMERIC NEOPRENE GASKET
CONFORMING TO ASTM-C564 STANDARD FOR WATER-TIGHT SEAL
WITH PIPE IN JOSAM INSIDE CAULK OUTLETS (-X).

**GASKET
JIFFEE JOINT**

 SERIES **19800**

TYPE NO.	DESIGNATION	FOR PIPE O.D.		A
		MIN.	MAX.	
19802	2" SW	2.125	2.390	1-1/2
19803	3" SW	3.125	3.390	1-3/4
19804	4" SW	4.125	4.390	2-1/4
19805	5" SW	5.210	5.390	2-1/2
19806	6" SW	6.210	6.390	2-5/8
19812	2" XH	2.290	2.470	1-1/2
19813	3" XH	3.410	3.590	1-3/4
19814	4" XH	4.410	4.590	2-1/4
19815	5" XH	5.410	5.590	2-1/2
19816	6" XH	6.410	6.590	2-5/8
19825	5" SP	5.550	5.700	2-1/2
19826	6" SP	6.550	6.700	2-5/8

DATE OF LAST CHANGE: 06/20/08

 DIMENSIONS ARE SUBJECT TO MANUFACTURERS
TOLERANCES AND CHANGE WITHOUT NOTICE.
WE CAN ASSUME NO RESPONSIBILITY FOR
USE OF SUPERSEDED OR VOID DATA.

JOSAM COMPANY
MICHIGAN CITY, INDIANA

NOTES

Installing JOSAM Products Using the JIFFEE-JOINT Gasket.

1. Set drain body to the proper height over pipe.
2. Level and support in place.
3. After coating gasket and inside of drain with a gasket lubricant, slip gasket over pipe and press down as far as possible by hand.
4. Placing a caulking tool in groove at top of gasket, drive the gasket down flush with the pipe top – no further. You have made a perfect joint.

GASKET-PIPE TABLE

TYPE NO.	CAST IRON		PVC			COPPER		
	SOIL PIPE XH	SW	NO HUB	PLASTIC ABS	THIN PVC WALL	STEEL DWV	GLASS	
19802	•				•	•	•	
19803	•				•	•		
19804	•				•	•		
19805	•							
19806	•							
19812	•		•	•	•	•	•	
19813	•			•	•	•	•	
19814	•			•	•	•	•	
19815	•							
19816	•							
19825				•	•	•		
19826				•	•	•	•	

SW – Service Weight XH – Extra Heavy SP – Steel Pipe

These recommendations apply to pipe that conforms to ANSI, ASTM and other applicable standards. JIFFEE-JOINT Gaskets are designed for use only with JOSAM caulk outlet (-X) products.

WARNING: Cancer and Reproductive Harm - www.p65warnings.ca.gov